

ELIQUARE

Efficient Energie-Saving Variable Frequency Water Pump User Guide



PA-16000 PA-20000 PA-23000 PA-25000

Dear Customer:

Thank you for choosing our product “water pump”. It’s designed as intelligent eight adjustable function, users can adjust the output according to their needs. Also it is super energy-saving, 70% high-efficient energy saving. Please read the instructions carefully before using the pump and keep it well, correct installation will maximize water pump’s efficiency and benefits, in order to reduce the occurrence of failure and effectively extend the service life.

Product Feature:

- It uses advance intelligent AC energy-saving technology, 70% high-efficient energy saving, super silent, long service life.
- Water shortage protection, overload protection, automatic fault detection, automatic start, no need to re-plug the power plug.
- The use of high strength wear resistant and corrosion resistant ceramic shaft ceramic set, long service life. It can be used in sea water and fresh water.
- 8 adjustable function, users can adjust the output according to their needs.
- It has memory function, every time restart the power will have the same parameters as before.

Operating Instructions:

- Please use 30mA rated current leakage switch to ensure safety.
- Please connect the pump and the controller before supply it power.
- There are 50% to 100% power adjustment press “BUTTON” to adjust the level, and displayed the current power level. User may choose the level according to their needs.
- The maximum dive depth is 1.5 meter.

Parameters of Control Panel:

- CPU will self-check when power on, and automatically start the pump after 3 seconds with LED flashing.

- Water shortage protection – run 1 minute even if detected anhydrous, stop for 12 seconds and restart for 15 seconds, shut off the output after 5 times. You must plug to restart the pump. (Automatic shut off the power would display with “LO”).
- Overload protection – when the power is more then 150% of the normal power, the CPU will immediately shut off the output into the protection state and display “OP”.
- Short-phase protection, when one of the phase line of the pump is block or short circuit, the CPU will automatically into protection state, and display “F3”.

Parameter of Water Pump:

MODEL	POWER	MIN.FLOW	MAX.FLOW	H.MAX	OUTLET	DIMENSIONS
PA-16000	40-80W	11600L/h	15300L/h	2.0M	75mm / 2inch	209x143x179mm
PA-20000	60-120W	13250L/h	17390L/h	2.0M	75mm / 2inch	209x143x179mm
PA-23000	70-140W	16960L/h	21500L/h	2.0M	75mm / 2inch	209x143x179mm
PA-25000	80-160W	18700L/h	23900L/h	2.0M	75mm / 2inch	209x143x179mm
INPUT VOLTAGE: 220V /50Hz						

Use Guidelines:

1. Diving:

- Install filter cap, to avoid sucking sands, please put 5cm flat stone below the pump, and connect the outlet pipe.
- To avoid sucking air into the pump, please fully submersible, and minimum depth is 15 cm.

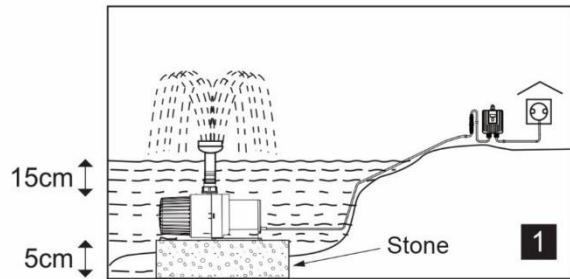

Installation for diving:

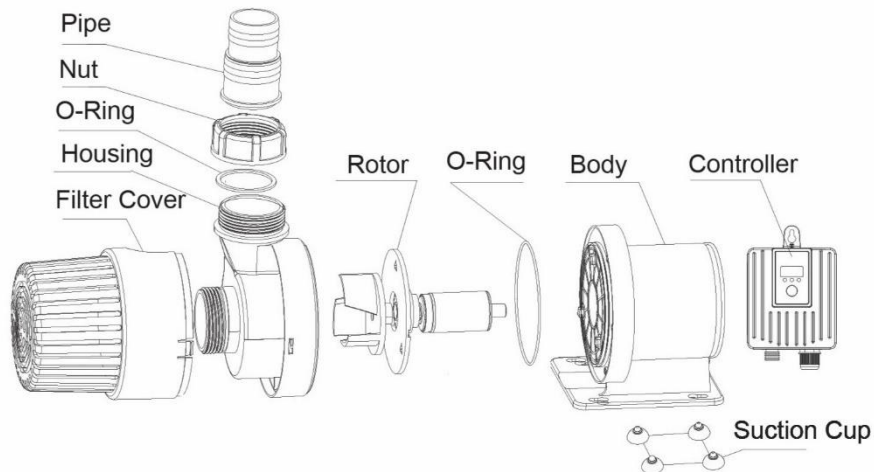

2. Not diving:

- Disassemble the filter cap (if supplied), place the pump at lower level than water surface. Install outlet pipe A and inlet B.
- To avoid sucking dirty things, place a filter cap at the water inlet C.
- To maximize the performance of the pump, reduce any bucking of pipe.

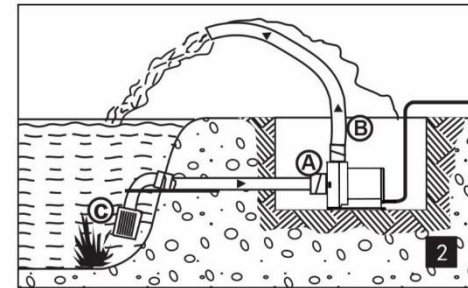

Installation for Not diving:

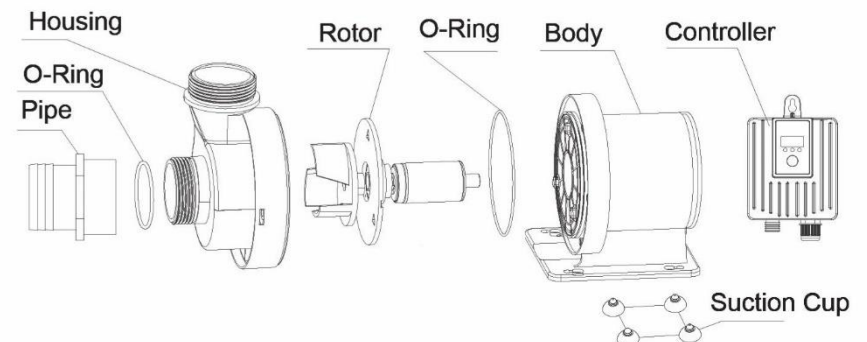

Safe Guidelines:

- Before using, please check the main connectors and plugs are all in standard requirement, please use 30mA rated current leakage switch to ensure safety.
- Please do not run without water.
- Please keep the electrical plug stays dry.
- Please do not plug the power plug into power supply when your hands are wet.
- When the pump is found abnormal, please contact sales department.
- The power voltage supplied must meet the rating voltage of the product.
- Please do not use the water which above 40 degrees Celsius.
- Please do not run the pump in flammable liquid.
- This product can be used diving or not diving:
 Diving: the maximum dive depth cannot be over 1.5 meter.
 Not diving: pipe joint should be good sealing. The pump should be placed lower than the water suction position.

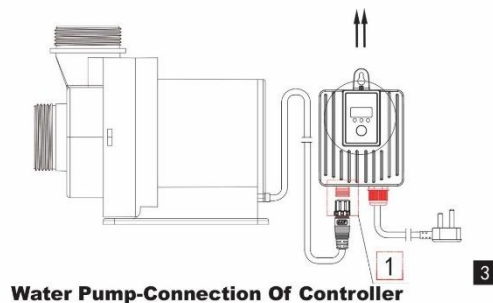
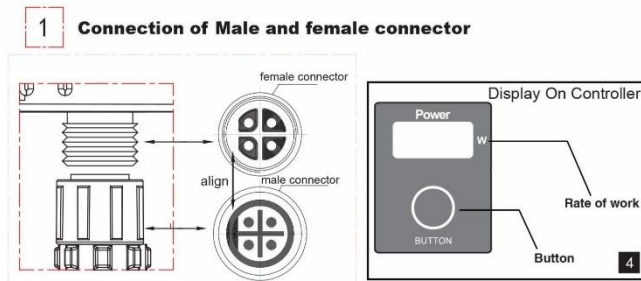

Maintenance:

- When you don't use the product, please unplug from power supply.
- Check if there are any dirty things block the water inlet and outlet. You may take filter mesh apart, loosen the screw, take house apart, take out rotor, use tiny brush and water to clean up dirty things. Note, waterleaf cannot be apart from the ceramic shaft.
- Check if there any crack on the motor, see if it can be free of moving.
- Keep the inner bore clear and clean.
- Please don't forget the O-ring and pvc when you are installing the product, tighten up the screw, install the sucking disc and pipe joint.
- Check the water pump is on good operating condition once a month, to ensure the longest service life.

Product warranty card:

Thank you for choosing our products. In order to make our service more satisfy for you, please carefully read and follow these instructions and keep the warranty card properly.

- Please keep shopping voucher and warranty card, and show them when it needs maintenance.
- Under normal use conditions, warranty period for parts of this product is 24 months. (Gifts do not belong to the scope of warranty).
- This product is applicable to the pond device, landscape gardens, filtration and cleaning of aquiculture water, indoor and outdoor scenic fountains.
- The following terms do not belong to the scope of warranty:
 - a. Unstandardized operations, installation error, placement error, transport damage.
 - b. Failure caused by user's improper maintenance.
 - c. Failure by using out of functional area.
 - d. Irresistible natural disaster or human error.
 - e. Failure by using irregular voltage.

- The losses caused by quality, must show the evidence photos and documents from relevant department within 3 days.
- Agents and users must fully and clearly complete each project on warranty card, in order to obtain the product warranty period. Otherwise, agents will be responsible for any dispute relate to warranty.
- Our company reserves the final power of interpretation for the above warranty clause.

Customer information

Production date: _____ Purchased date: _____
Production model: _____ Invoice number: _____
Customer name: _____ Tel.: _____
Retailer: _____ Mobile: _____

	Date	Fault	User signature	Mechanics
Repair record				



DVS-Filtertechnik B.V.
Wiebachstraat 41
6466 NG - Kerkrade
www.dvs-filtertechnik.com